

SECURITHERM BIOCLIP thermostatic basin mixer

Ref. H9605610L

Single hole, sequential thermostatic mixer H. 95mm L. 120mm







DESCRIPTION

SECURITHERM BIOCLIP thermostatic basin mixer - Ref. H9605610L



Deck-mounted SECURITHERM thermostatic basin mixer.
Sequential thermostatic mixer: opens and closes with cold water.
No risk of cross flow between the hot and cold water.
No non-return valves on the inlets.
BIOCLIP: can be easily removed for cleaning and disinfection.
Anti-scalding failsafe: shuts off automatically if the cold or hot water supply fails.
Securitouch thermal insulation prevents burns.
Single hole mixer with straight spout, H. 95mm L. 120mm, fitted with a hygienic flow straightener, with no build-up of impurities and withstands thermal shocks.
Scale-resistant sequential thermostatic cartridge for single control adjustment of flow rate and temperature.
Adjustable temperature from cold water up to 40°C with maximum temperature limiter set at 40°C.
Thermal and chemical shocks are possible.
Spout and body with smooth interiors and low water volume.
Flow rate limited to 5 lpm at 3 bar.
No manual contact thanks to Hygiene control lever L. 100mm.
Without pop-up waste.
Supplied with copper tails and chrome-plated brass stopcocks.
Fixing reinforced via 2 stainless steel rods.
Mixer ideal for healthcare facilities, retirement and care homes, hospitals and clinics.
Mixer suitable for people with reduced mobility.
30-year warranty.
Also available with PEX flexibles.

ADVANTAGES

-  Maximum hygiene: no non-return valves
-  Hygiene: can be removed for internal cleaning
-  SECURITHERM: anti-scalding safety
-  Sequential: opens/closes with cold water

TECHNICAL CHARACTERISTICS

SECURITHERM BIOCLIP thermostatic basin mixer - Ref. H9605610L

| | |
|---------------------|---|
| Connector | M1/2" Ø 15mm |
| Technology | SECURITHERM BIOCLIP sequential Securitouch |
| Drop height | 95mm |
| Spout length | 120mm |
| Flow rate | 5 lpm at 3 bar |
| Temperature limiter | Yes |
| Finish | Chrome-plated brass |
| Norms |   |

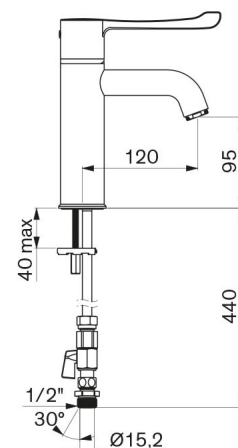

Warranty

