

SECURITHERM BIOCLIP

thermostatic basin mixer

Ref. H9605610

Single hole sequential thermostatic mixer H. 95mm L. 120mm



DESCRIPTION

SECURITHERM BIOCLIP thermostatic basin mixer - Ref. H9605610

Deck-mounted SECURITHERM thermostatic basin mixer.
 Sequential thermostatic mixer: opens and closes with cold water.
 No risk of cross flow between the hot and cold water.
 No non-return valves on the inlets.
 BIOCLIP: mixer can be easily removed for cleaning and disinfection.
 Anti-scalding failsafe: shuts off automatically if cold or hot water supply fails.
 Securitouch thermal insulation prevents burns.
 Single hole mixer with curved spout, H. 95mm L. 120mm, fitted with a hygienic flow straightener, no build-up of impurities and withstands thermal shocks.
 Scale-resistant sequential thermostatic cartridge for single control adjustment of flow rate and temperature.
 Temperature adjusts from cold water up to 40°C with maximum temperature limiter set at 40°C.
 Thermal and chemical shocks are possible.
 Spout and body with smooth interior and low water volume.
 Flow rate limited to 5 lpm at 3 bar.
 No manual contact thanks to Hygiene control lever L. 146mm.
 Without pop-up waste.
 Supplied with copper tails and chrome-plated brass stopcocks.
 Fixing reinforced via 2 stainless steel rods.
 Ideal for healthcare facilities, retirement and care homes, hospitals and clinics.
 Mixer suitable for people with reduced mobility.
 Mixer with 30-year warranty.
 Also available with PEX flexibles.





TECHNICAL CHARACTERISTICS

SECURITHERM BIOCLIP thermostatic basin mixer - Ref. H9605610

| | |
|---------------------|---|
| Connector | M1/2", Ø 15mm |
| Technology | SECURITHERM BIOCLIP sequential thermostatic mixer |
| Drop height | 95mm |
| Spout length | 120mm |
| Flow rate | 5 lpm at 3 bar |
| Temperature limiter | Yes |
| Finish | Chrome-plated brass |
| Norms |   |
| Warranty |  |



ADVANTAGES

-  Maximum hygiene: mixer has no non-return valves
-  Hygiene: can be removed for internal cleaning
-  SECURITHERM: anti-scalding safety
-  Sequential: opens/closes with cold water

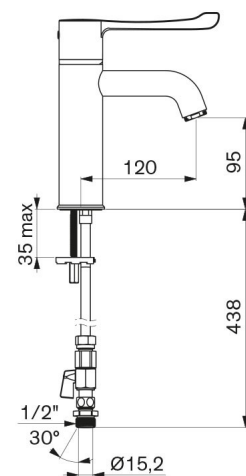

Repairability

