

# SECURITHERM BIOCLIP

## thermostatic basin mixer

Ref. H960515

Single hole sequential thermostatic mixer H. 95mm L. 120mm





### DESCRIPTION

**SECURITHERM BIOCLIP thermostatic basin mixer - Ref. H960515**

Deck-mounted SECURITHERM thermostatic basin mixer.  
 Sequential thermostatic mixer: opens and closes with cold water.  
 No risk of cross flow between the hot and cold water.  
 No non-return valve.  
 BIOCLIP: mixer can be easily removed for cleaning and disinfection.  
 Anti-scalding failsafe: shuts off automatically if cold or hot water supply fails.  
 Securitouch thermal insulation prevents burns.  
 Single hole mixer with curved spout, H. 95mm L. 120mm, fitted with a hygienic flow straightener, no build-up of impurities and withstands thermal shocks.  
 Scale-resistant sequential thermostatic cartridge for single control adjustment of flow rate and temperature.  
 Temperature adjusts from cold water up to 40°C with maximum temperature limiter set at 40°C.  
 Thermal and chemical shocks are possible.  
 Body and spout with smooth interiors and low water volume.  
 Flow rate limited to 5 lpm at 3 bar.  
 No manual contact thanks to Hygiene control lever L. 146mm.  
 No pop-up waste.  
 Supplied with F3/8" PEX flexibles with chrome-plated brass stopcocks, filters and Ø 15mm conical connectors.  
 Fixing reinforced via 2 stainless steel rods.  
 Mixer ideal for healthcare facilities, retirement and care homes , hospitals and clinics.  
 Mixer suitable for people with reduced mobility.  
 30-year warranty.  
 Also available with copper tails.

### TECHNICAL CHARACTERISTICS

**SECURITHERM BIOCLIP thermostatic basin mixer - Ref. H960515**

|                     |   |
|---------------------|---|
| Connector           | M1/2", Ø 15mm   |
| Technology          | SECURITHERM BIOCLIP sequential thermostatic mixer   |
| Drop height         | 95mm  |
| Spout length        | 120mm   |
| Flow rate           | 5 lpm at 3 bar  |
| Temperature limiter | Yes   |
| Finish              | Chrome-plated brass   |
| Norms               |   |

### ADVANTAGES



Maximum hygiene: mixer with no non-return valves



Hygiene: can be removed for internal cleaning



SECURITHERM: optimal anti-scalding safety



Sequential: opens/closes with cold water

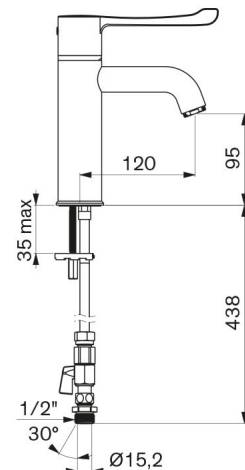

---

Warranty



---

Repairability

