

SECURITHERM BIOCLIP

thermostatic basin mixer

Ref. H96051

Single hole, sequential thermostatic mixer H. 95mm L. 120mm



DESCRIPTION

SECURITHERM BIOCLIP thermostatic basin mixer - Ref. H96051

Deck-mounted thermostatic SECURITHERM basin mixer.
 Sequential thermostatic mixer: opens and closes with cold water.
 No risk cross flow between the cold and hot water.
 No non-return valves on the inlets.
 BIOCLIP: mixer is easy to remove for cleaning and disinfection.
 Anti-scalding failsafe: shuts off automatically if cold or hot water supply fails.
 Securitouch thermal insulation prevents burns.
 Single hole mixer with curved spout H. 95mm L. 120mm fitted with a hygienic flow straightener with no impurity retention and thermal shock-resistant.
 Scale-resistant sequential thermostatic cartridge for single control of flow rate and temperature.
 Temperature adjusts from cold water up to 40°C with temperature limiter set at 40°C .
 Thermal and chemical shocks are possible.
 Body and spout with smooth interiors and low water volume.
 Flow rate limited to 5 lpm at 3 bar.
 No manual contact thanks to Hygiene control lever L. 146mm.
 No pop-up waste.
 F3/8" PEX flexibles.
 Fixing reinforced by 2 stainless steel rods.
 Ideal for healthcare facilities, retirement and care homes, hospitals and clinics.
 Mixer suitable for people with reduced mobility.
 30-year warranty.
 Also available with copper tails.





TECHNICAL CHARACTERISTICS

SECURITHERM BIOCLIP thermostatic basin mixer - Ref. H96051

Connector	F3/8"
Technology	SECURITHERM BIOCLIP sequential Securitouch
Drop height	95mm
Spout length	120mm
Flow rate	5 lpm at 3 bar
Temperature limiter	Yes
Finish	Chrome-plated brass
Norms	ACS  
Warranty	



ADVANTAGES

-  Maximum hygiene: mixer with no non-return valves
-  Hygiene: can be removed for internal cleaning
-  SECURITHERM: Optimal anti-scalding safety
-  Sequential: opens/closes with cold water

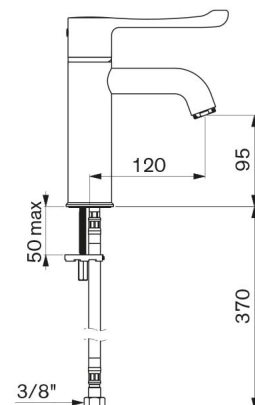

Repairability

